

Yomitan

Kina Banjo
(Former Village Office)

Area Guide

Historical Shukuba Town
of the Kingdom of the Ryukyus

KINA BANJO

(Tourist Information Center)

2015 ClickOkinawa.com

During the heyday of the Ryukyuan Kingdom, Yomitan Village prospered as a hub of tributary trade with Imperial China. It developed its unique character by assimilating the influences of other cultures and countries.

KINA BANJO

Kina, as home to a banjo or what we today would call a government office, thrived as a government administrative center. A shukumichi, or direct road linking Shurijo Castle with the hills of Yanbaru, passed in front of the Kina Banjo. Kina therefore served an important role as an overnight stop for passing travelers, their culture, and commercial goods.

Kina Banjo (Etching by Heine)

The artist Heine composed the work during the exploration of the Ryukyus by members of the Commodore Perry expedition.





The Pre-WWII Yuntanza Village Office

Photo circa 1935-1945



Bird-eye photo taken during Battle of Okinawa

Yuntanza Village Office and environs just before 1945 U.S. landing



Yomitan Village in Central Okinawa Island

- Area: 35.17㎢
- Population: 38,575 (male 19,244 / female 19,331) (as of Dec. 2005)
- Village Established: April 1, 1908
- Products: Yuntanza Hanau Textile, Pottery, Awamori Liquor, Purple Yam, Handblown glass
- Village tree: Fukugi
- Village Flowering Tree: Golden Trumpet Tree
- Village flower: Bougainvillea



Future Town Development

鳳一飛凰花葉黄金環

The abundance of nature
The warmth of hearts
A flourishing culture
Are the tenets of our village



Kina Banjo and Vicinity

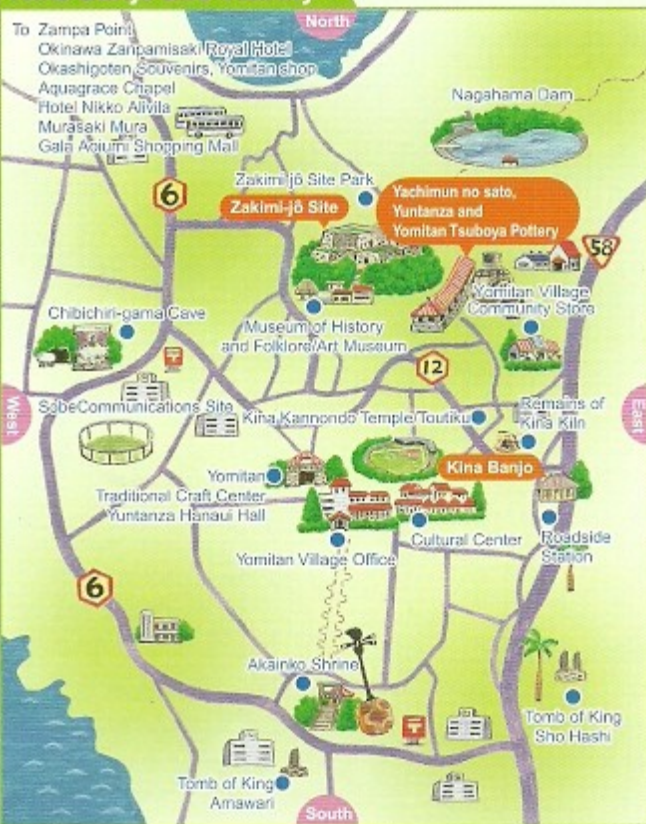

Kina Banjo Area Guide

(Former Village Office)

Published by: Commerce and Tourism Division,
Construction and Economy Department,
Yomitan Village Office
2901 Zakimi, Yomitan Village, Okinawa
Prefecture 904-0392
tel.098-982-9200 <http://www.yomitan.jp>



Designed and Edited by: Kuniken Ltd. tel.098-862-1106
Supervised by: PROJECT CORE Inc. tel.098-957-1772
Printed by: Marumasa Printing Co. tel.098-835-8181

Following traces of shukumichi, road of the Kingdom of the Ryukyus



Kina Banjo

Kina Banjo aligns with the central Nakagami area. After the Perry expedition and the Abolishment of the Ryukyu Kingdom, Kina Banjo became the center of Yonabaru District and then the center of Yonabaru City. Kina Banjo - used to have an original atmosphere between 9:00 am and 5:00 pm.



The old Kina Race Track

The stretch of road some 200 to 300 meters south from Kina Banjo was often used as a horse race track until the late Meiji era. A celebrated line of large Ryukyuan pines aligned the road in pre-WWII days.



Kina Kannondo Temple/Toutiku

Kina Kannondo was built in 1841 as the new home for the famous Kannon Temple from Kin. Before WWII, the temple hall housing the stone sculpture of the Goddess of Mercy was fenced with stone and boasted a fired tile roof. A small shrine for Toutiku, God of the Harvest, was later added on the eastern boundary of the Temple.

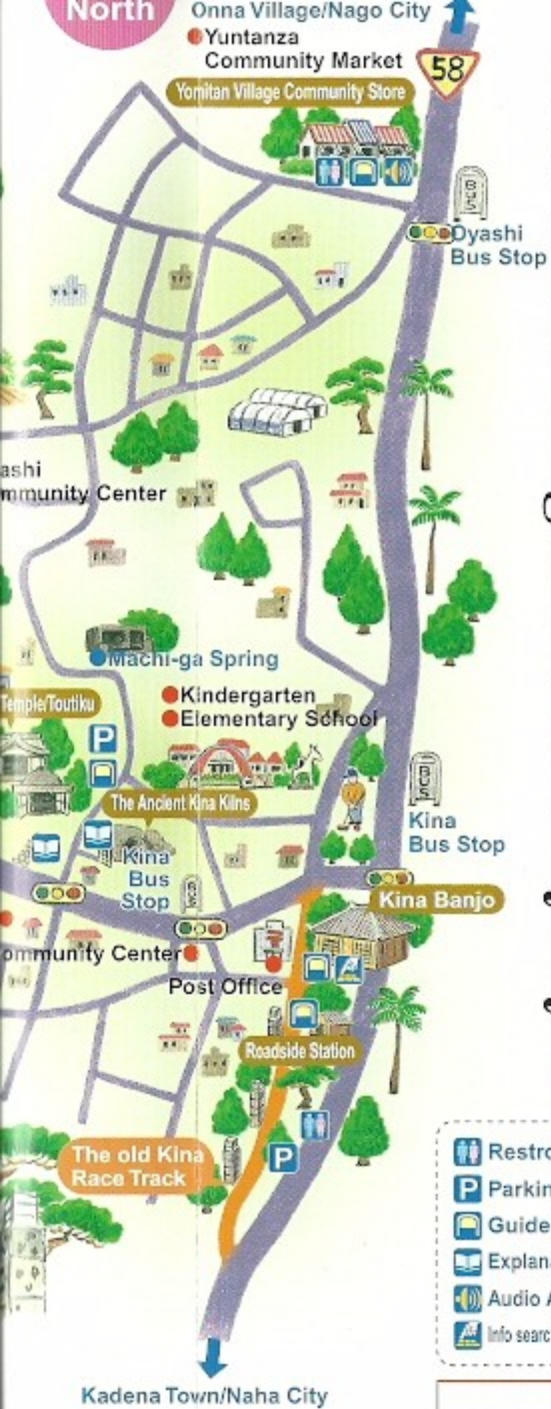

Following traces of shukumichi, road of the Kingdom of the Ryukyus



Kina Banjo

Kina Banjo aligns the main road connecting Shuri Castle to the central Nakagami and northern Kunigami regions. Members of the Perry expedition visited the banjo in 1853. With the 1897 Abolishment of the Clans and Establishment of Prefectures, the banjo became the administrative center of the magiri (government district) and then the Yuntanza Village Office in 1908, serving as the center of Yomitan's political and administrative affairs. The old banjo - used today as a tourist information center -- retains the original atmosphere of its history. The center is open everyday between 9:00 am to 6:00 pm except for Mondays.



Info search engine et al (image)



Floor Plan of Kina Banjo

Entrance / Exit



Exhibition floor in the Banjo(image)

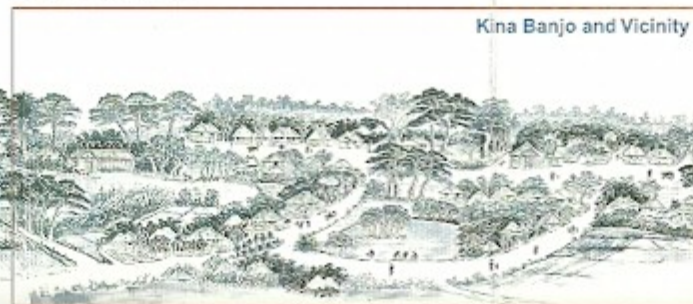

Kina Banjo and Vicinity



Pre-WWII Scenery of the Kina Banjo vicinity
(artist: Ryoshu Miyahira)



jo
 s the main road connecting Shuri Castle to the
 and northern Kunigami regions. Members of
 ion visited the banjo in 1853. With the 1897
 the Clans and Establishment of Prefectures, the
 administrative center of the magiri (government
 the Yuntanza Village Office in 1908, serving as
 itan's political and administrative affairs. The old
 ay as a tourist information center -- retains the
 ers of its history. The center is open everyday
 to 6:00 pm except for Mondays.



Info search engine et al (image)

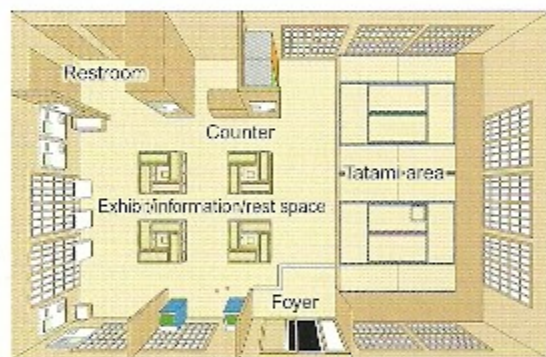

Floor Plan of Kina Banjo

Entrance / Exit



Exhibition floor in the Banjo(image)

Kina Banjo and Vicinity



Pre-WWII Scenery of the Kina Banjo vicinity
 (artist: Ryoshu Miyahira)



The Ancient Kina Kilns

An extensive collection of pottery is preserved here, the home of "Kina Pottery." A 2003 archaeological survey uncovered three pottery kilns, turning the kilns of legend into identifiable sites. Today, the kiln sites are preserved and partially open to the public.



Kina Performing Arts

Kina retains many of its traditional performing arts, including its eisa dance. During Hatasugashi Festival held July 16 of the lunar calendar, youth and children's groups, led by banner bearers, parade through the community to the sounding of gongs and drums.